





A light, bright and beautifully presented home offering quite exceptional accommodation, located minutes from the railway station and Clarence Park, and an easy walk from the city centre.

£1,525 per month

A stunning and very generous two-bedroom cottage. The accommodation briefly comprises living room, dining room, modern kitchen, utility area, cloakroom, with a luxury bathroom and two double bedrooms to the first floor. Externally is a beautifully presented front paved area. To the rear is a paved terrace with steps to the private garden and shed.

Must be viewed!

To Let Unfurnished.

EPC Rating: C

Council Tax Band: D

Open Day: 29th of October between 2.15pm - 3.30pm
by appointment only

Available 25th November 2022





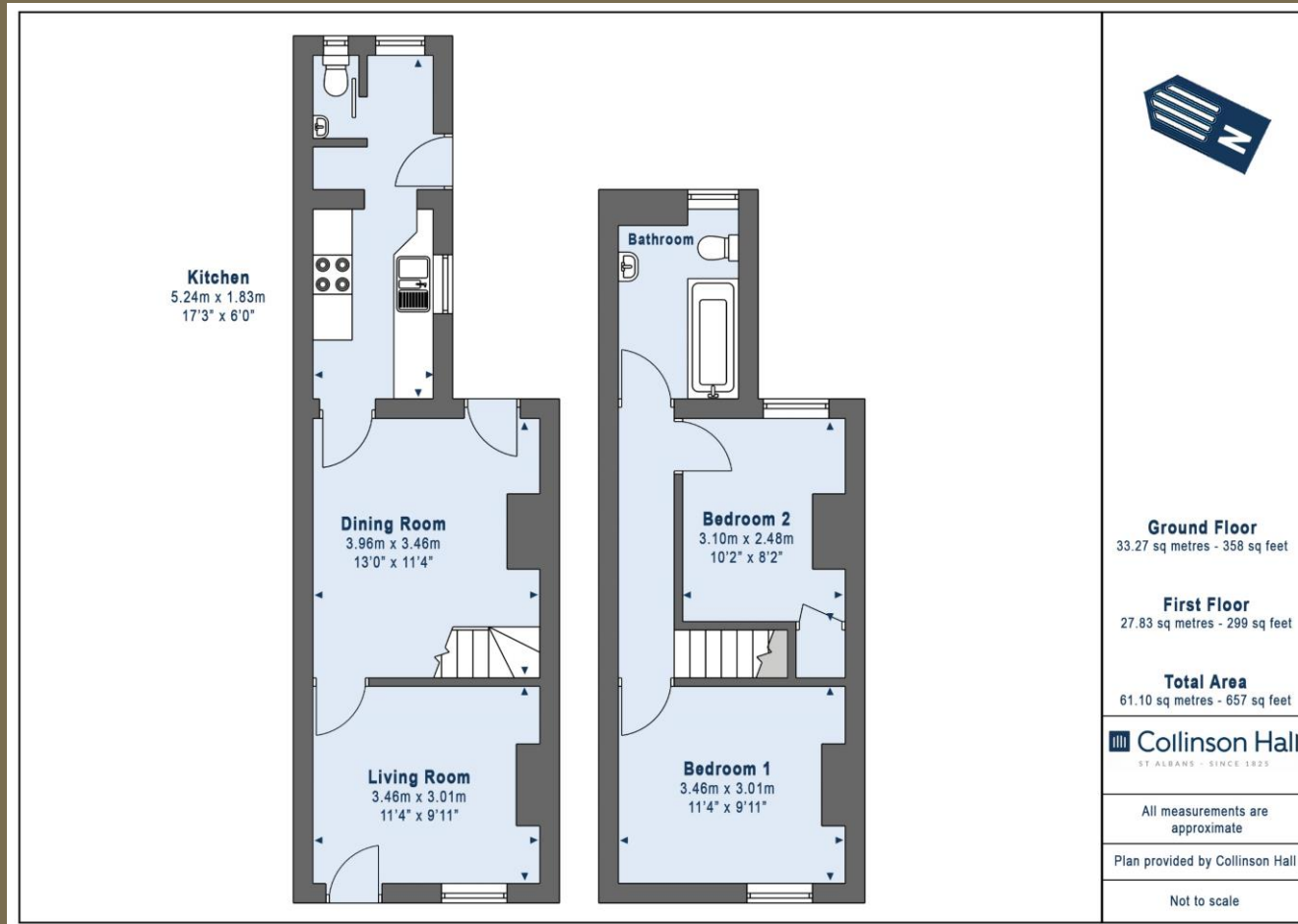

PLEASE NOTE

These particulars do not constitute an offer or contract in whole or in part. Please note that these details have been prepared for prospective purchasers as a general guide. We have endeavoured to be accurate in their preparation, but any intending purchaser should not rely on them as statements or representations of fact. In respect of the floor plans, these are for illustrative purposes only and room sizes are approximate and rounded: they are taken between internal wall surfaces and therefore may include cupboards/shelves, etc. No responsibility is taken for any error. Accordingly they should not be relied upon for carpets and furnishings. The services, systems and appliances at the property have not been tested and no guarantee as to their operability or efficiency can be given.



collinsonhall.co.uk

City Centre Office: 9-11 Victoria Street | St Albans | Hertfordshire | AL1 3UB | Telephone: 01727 843222 | Email: stalbansmail@collinsonhall.co.uk