







Positioned on the top floor of this **PRESTIGIOUS APARTMENT** block, is a **FABULOUS THREE BEDROOM** apartment offered with **NO ONWARD CHAIN**.

**Guide Price: £650,000**

The property offers stylish and spacious living with over 1170 square feet of light and airy accommodation. There is a fantastic open plan living/dining/kitchen room with Bi-fold doors onto a good size wrap around balcony with far reaching views. All three bedrooms are generous sizes with the principle bedroom having a super king sized bed, enjoying sliding doors onto the balcony and a spacious four piece bathroom. There is also a separate shower room, fitted wardrobes to all bedrooms, utility room and an excellent level of storage space throughout. Lansdowne Place is meticulously maintained with well tended communal gardens, lift serving all floors and allocated parking for one vehicle with several visitor spaces.

EPC Rating: TBC

Council Tax Band: F

Lease Information: This block benefits from a share of freehold.







good  
vibes  
only

Entrance Hall

Kitchen/Living/Dining 5.85m x 5.45m (19'2" x 17'11").

Utility Room

Bedroom 1 4.28m x 3.55m (14'1" x 11'8").

Bathroom

Bedroom 2 4.25m x 3.02m (13'11" x 9'11").

Walk - In - Wardrobe

Bedroom 3 3.59m x 3.01m (11'9" x 9'11").

Shower Room

Balcony

Communal Gardens

Allocated Parking









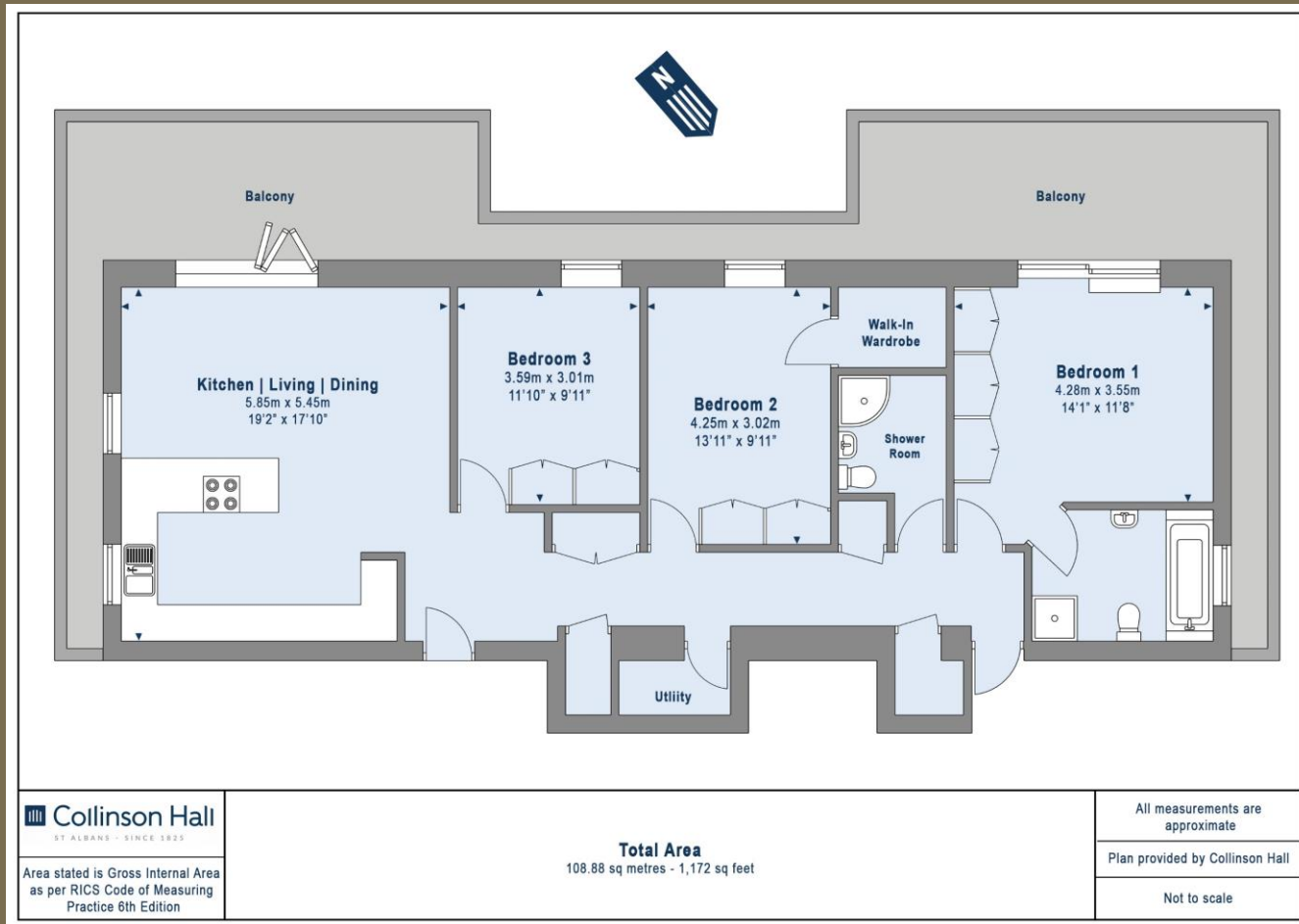

**PLEASE NOTE**

These particulars do not constitute an offer or contract in whole or in part. Please note that these details have been prepared for prospective purchasers as a general guide. We have endeavoured to be accurate in their preparation, but any intending purchaser should not rely on them as statements or representations of fact. In respect of the floor plans, these are for illustrative purposes only and room sizes are approximate and rounded: they are taken between internal wall surfaces and therefore may include cupboards/shelves, etc. No responsibility is taken for any error. Accordingly they should not be relied upon for carpets and furnishings. The services, systems and appliances at the property have not been tested and no guarantee as to their operability or efficiency can be given.



[collinsonhall.co.uk](http://collinsonhall.co.uk)

City Centre Office: 9-11 Victoria Street | St Albans | Hertfordshire | AL1 3UB | Telephone: 01727 843222 | Email: [stalbansmail@collinsonhall.co.uk](mailto:stalbansmail@collinsonhall.co.uk)

